

Halloween Experience 2017: Dungeon of the Doomed

SCENE C/D: GUILLOTINE, VICTIM AND OPERATOR

SEPTEMBER 2017, JAMES BULLOCK

Included are sketches showing the pieces required for assembly of the guillotine prop. Discussed also is the frame for movement of the 'victim' figure.

The guillotine was constructed using CLS timber for the frame and MDF for the lunette. The blade was also made from MDF and sprayed with a metallic silver paint. The frame comprised two pieces of timber spaced apart with full-length MDF pieces, to provide a 'slot' in which the blade could slide vertically.

From TOP

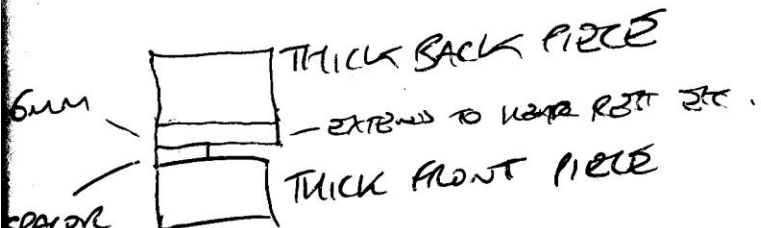

BLADE GOES BEHIND REST.

800mm pieces top + bottom with pulley

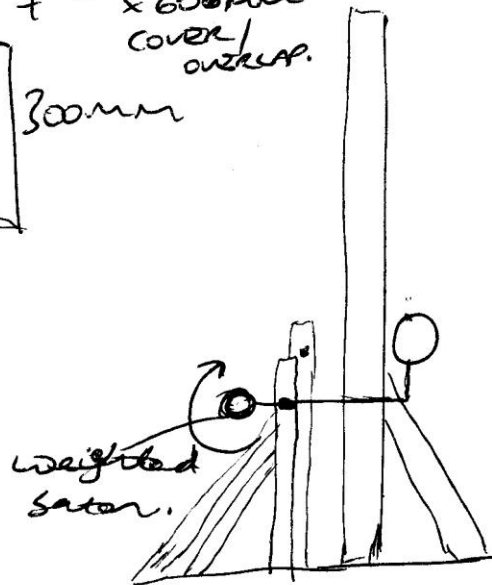
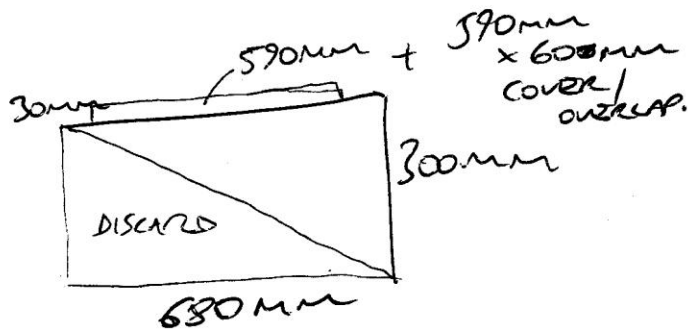
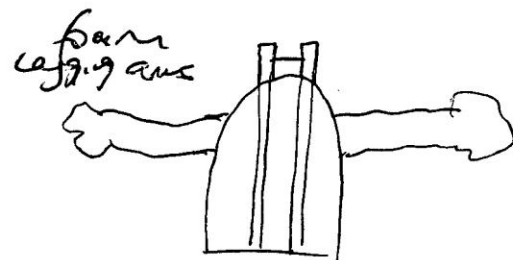
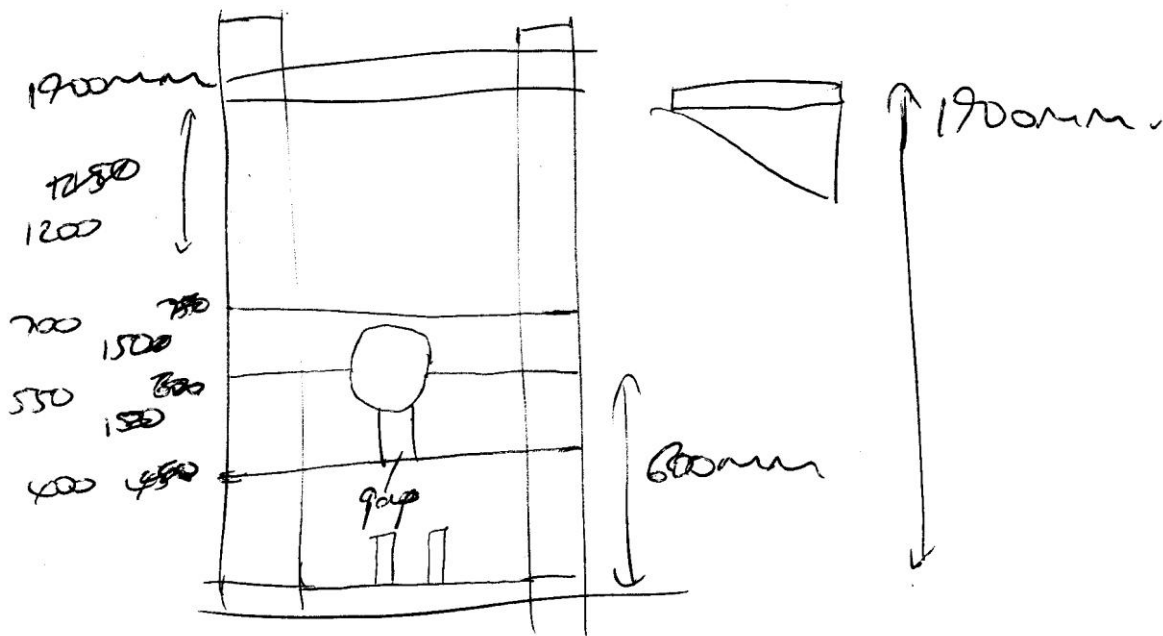
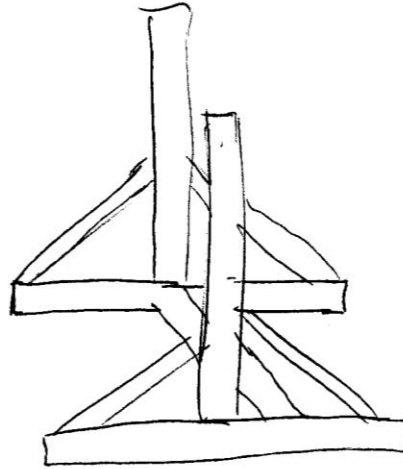
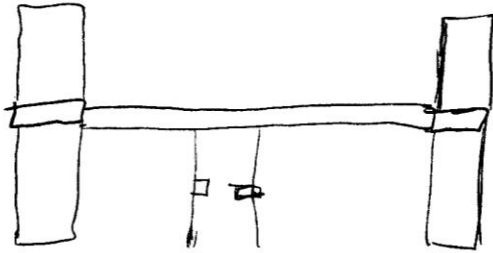

figure 15 the pivot point.

so...



FROM THE SIDE



putting piece

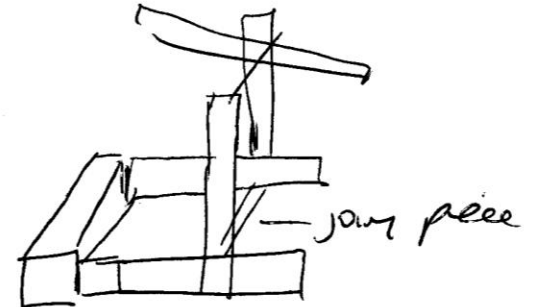

distance?

narrower
seam from
stop

paint black to disguise

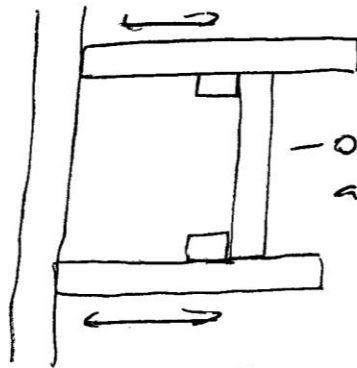

- only
about 100mm
MAX.
cut once rest
assembled.

THIS CAN BE CUT TO FIT MANUALLY.
MADE OUT OF BATTENS / B&Q NARROW.

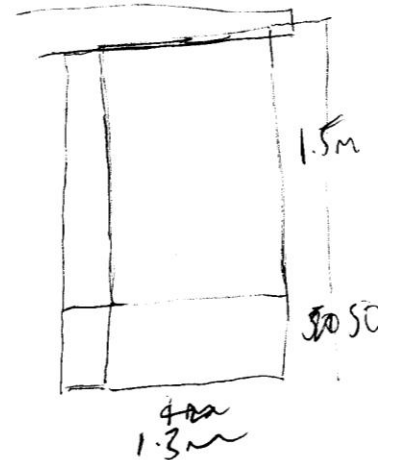

GUILLOTINE

FRONT

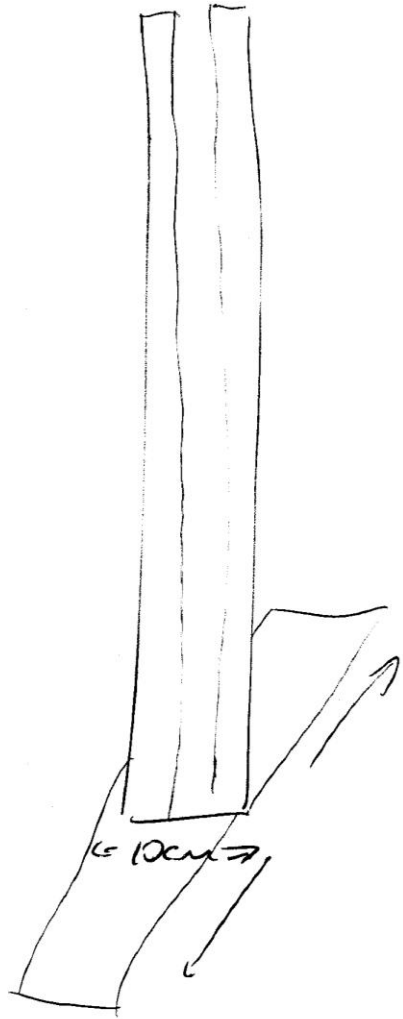

TOTAL WIDTH 800mm
BLADE WIDTH 680

600mm ~~blade~~ 9mm.
600mm ~~blade~~ overlap.
or 8cm.
2 slats
stuck
on
backboard.

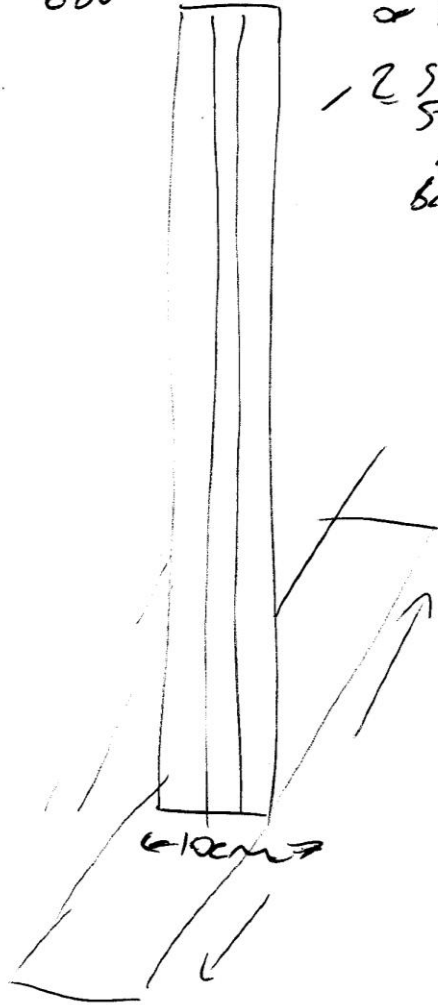

TOP

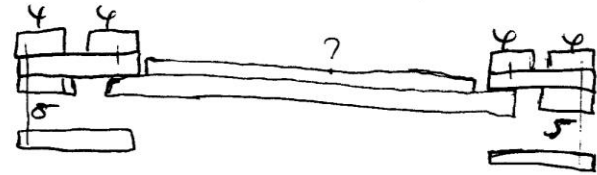

BACK

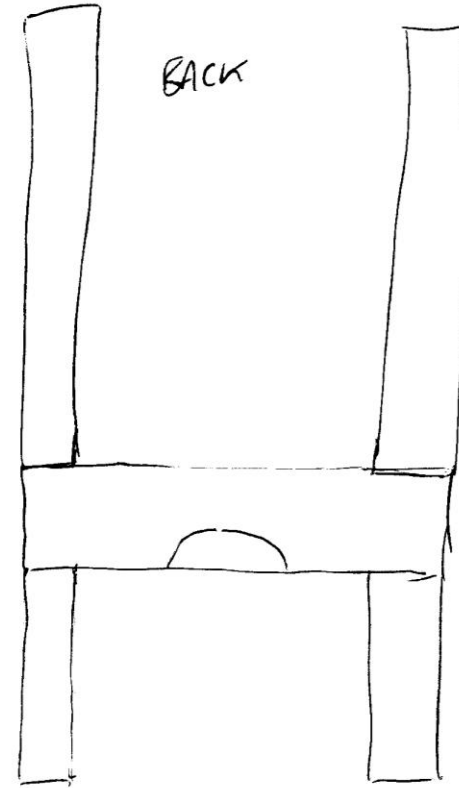

INTERVALS

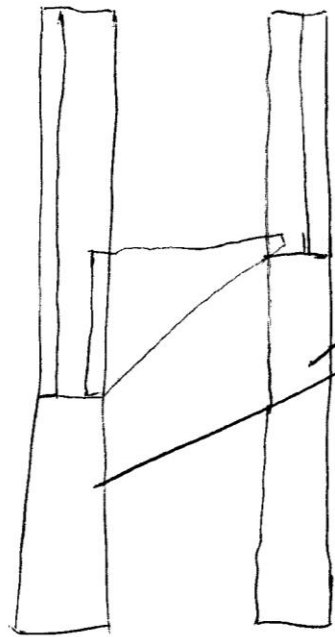

lap of foam/soft pads

full width
stops
to halt
blade fall

use thick foam and sacr
side
BQ seton

gradient for front legs should be steep. 200mm long x 4.

ideally. big piece of floor ~~that~~ ~~is~~

rear piece is

front piece is

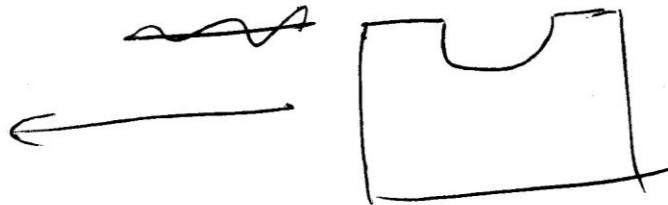
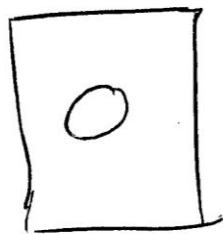

user tape etc to
go down
inside of
sides, to
create another
mm or so
of a gap
for ease
falling side

BLADE

570 625 680

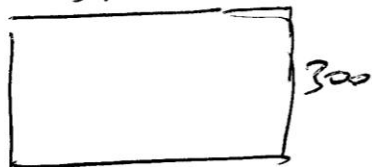

570 x 300
625
+ 570 x 30
570 x 60

610 x 30

610 x 60

620 625

180 700

80
90 + 90 = 180
80 - 150 = 620

44

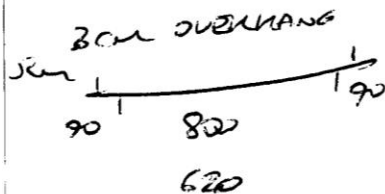

LAYER 1



LAYER 2

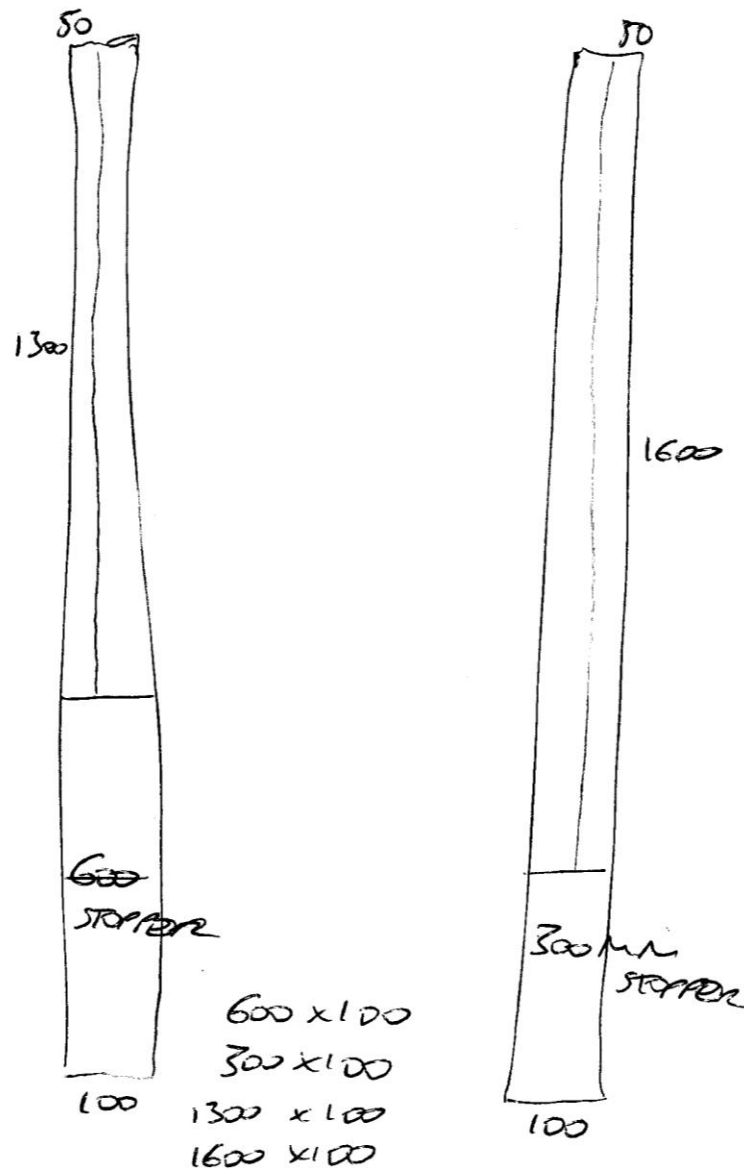

LAYER 3 + 4

X 4
SIDES-

1900
x 90

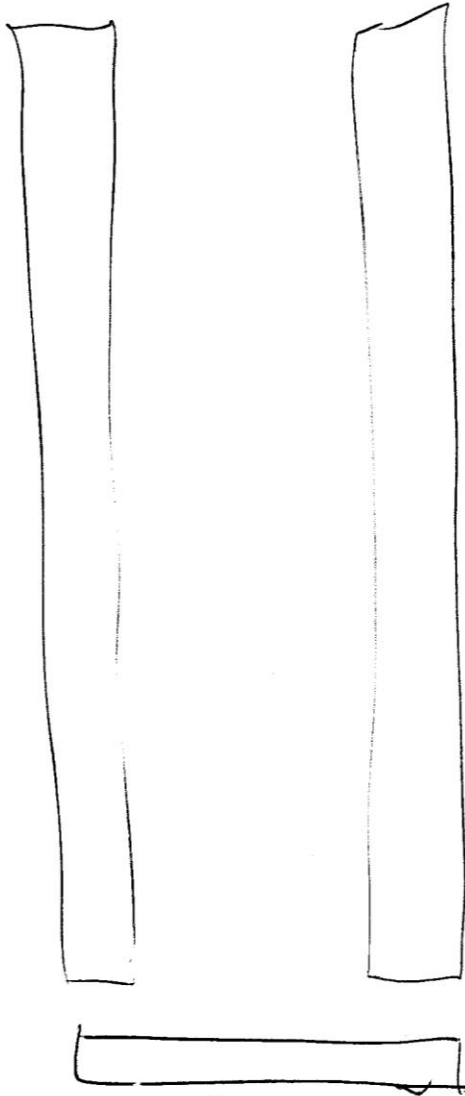

1900
x 90

+ 800mm
STRUTS + 4
FOR SUPPORTS.

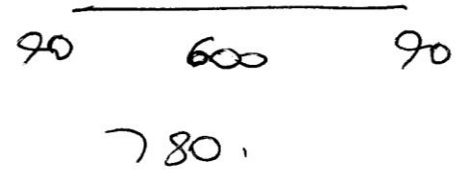

800mm
x 2 TOP + BOT.